

BASICLOGO BD ... XM - BASICLOGO BD ... EXM

Ersatzteile - Spare parts - Pièces de rechange - Reserveonderdelen - Parti di ricambio - Reservedele - Reservdelar
 Varaoasat - Części zamienne - Náhradní díly - Alkatrészek - Piese de schimb - Запасные части - 备件

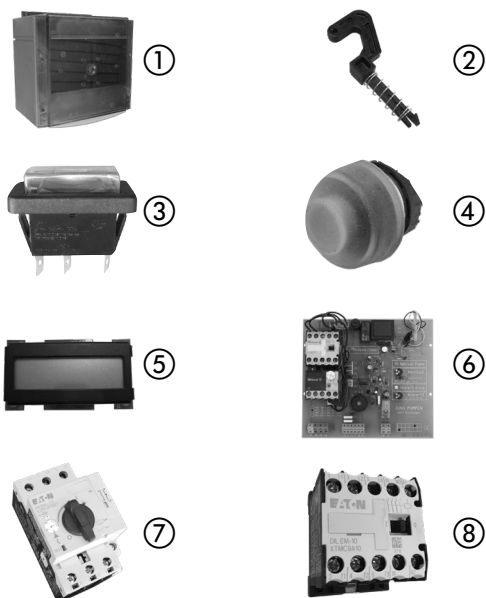

① Gehäuse A	Housing A	JP47692
② Scharnier	Hinge	JP48310
③ Wippschalter	Switch, 3 positions	JP47783
④ Taster	Button	JP48309
⑤ Betriebsstundenzähler	Operation hours counter	JP47672
⑥ Gedruckte Schaltung	PCB	JP47734
⑦ Motorschutzschalter	Protective motor switch	
	2,5-4 A	JP47753
	4-6,3 A	JP47754
	6,3-10 A	JP47755
⑧ Schütz DIL EM 10	Contactor EIL EM 10	JP47671

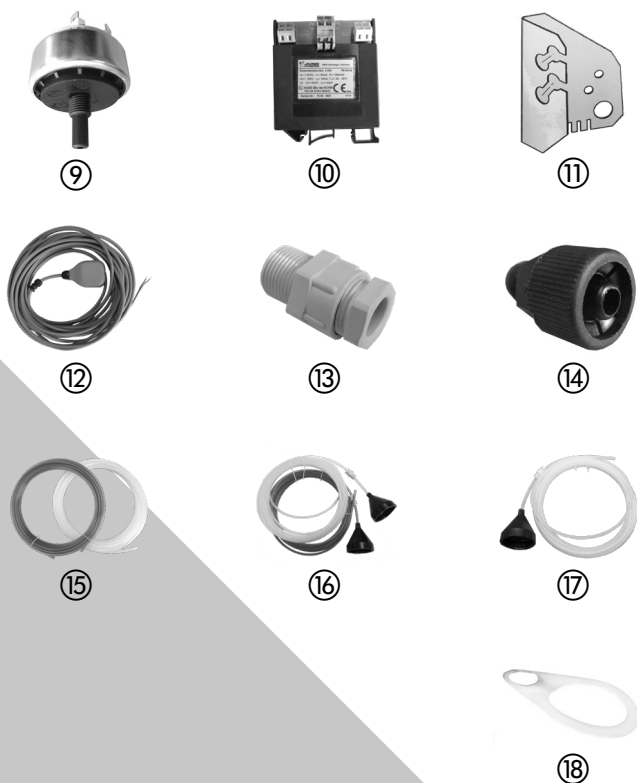

Niveaugeber	Level detector	
⑨ Druckschalter 100/50	Pressure switch	JP47699
⑩ Sicherheitsbarriere	Safety barrier ATEX	JP46348
⑪ TLS Halter		JP46456
⑫ TLS Tauchschalter 9,5m		JP48304
	TLS Tauchschalter 15 m	JP48873
	TLS Tauchschalter 20 m	JP47771
	TLS Tauchschalter 30 m	JP47772
⑬ 2x Schlauchbefestigung	2x Hose fastening	JP48141
⑭ 2x Verschraubung	2x Hose connector	JP48142
⑮ 2x Schlauch, 10m	2x Hose, 10m	JP48143
	2x Schlauch, 15m	JP48144
	2x Schlauch, 20m	JP48145
	2x Schlauch, 30m	JP48840
⑯ Luftglockenset, 10m	Pressure sensor set, 10m	JP48148
⑰ Luftglocke m Schlauch, 10m	Press. sensor w hose, 10m	JP47698
⑱ 20x Fangflasche	20x Catch hanger	JP46904